

ULTIME D Patented

Metalfire

Technical Document

ULTIME D MF 1050-50 WHE T

Dimensions (mm)

- combustion opening WxH: 1086 x 506
- external WxDxH: 1261 x 620 x 1819
- fresh air intake: 2 x $\varnothing 150$
- flue gas outlet: $\varnothing 250$

Technical Data

- ecolabel: A
- capacity: 25.2kW
- efficiency: 79%
- CO (volume with 13%O₂): 0.05%
- dust (volume with 13%O₂): 30mg/Nm³
- weight: 400kg
- convection air inlet: min.700cm² (4 x $\varnothing 150$)
- convection air outlet: min.700cm² (4 x $\varnothing 150$)

First aid and technical support:

- support@metalfire.eu
- +32 9 261 51 90

scale 1:20

www.metalfire.eu EN 13229

General dimensional tolerances up to 6mm
Metalfire preserves the right to modify specifications without previous notice

Rev.
A

CE

Sheet
1/3

Without finishing frame

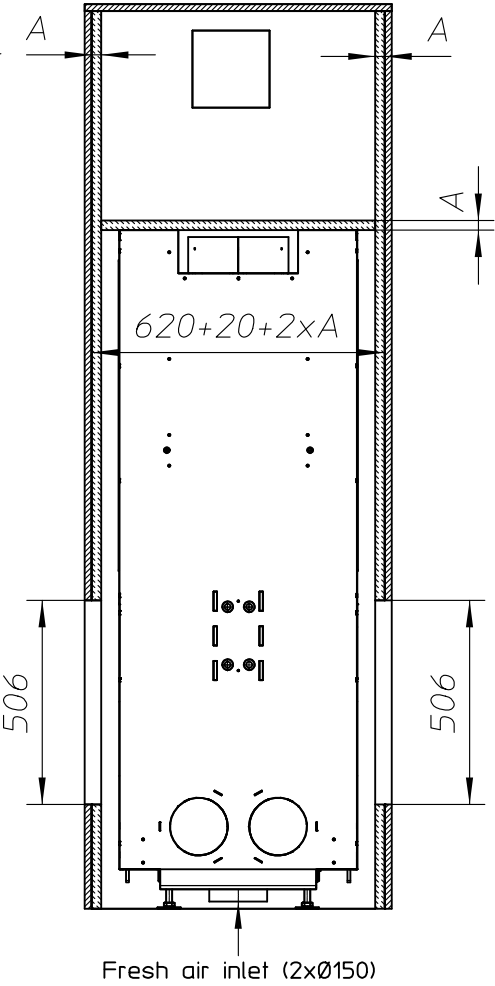
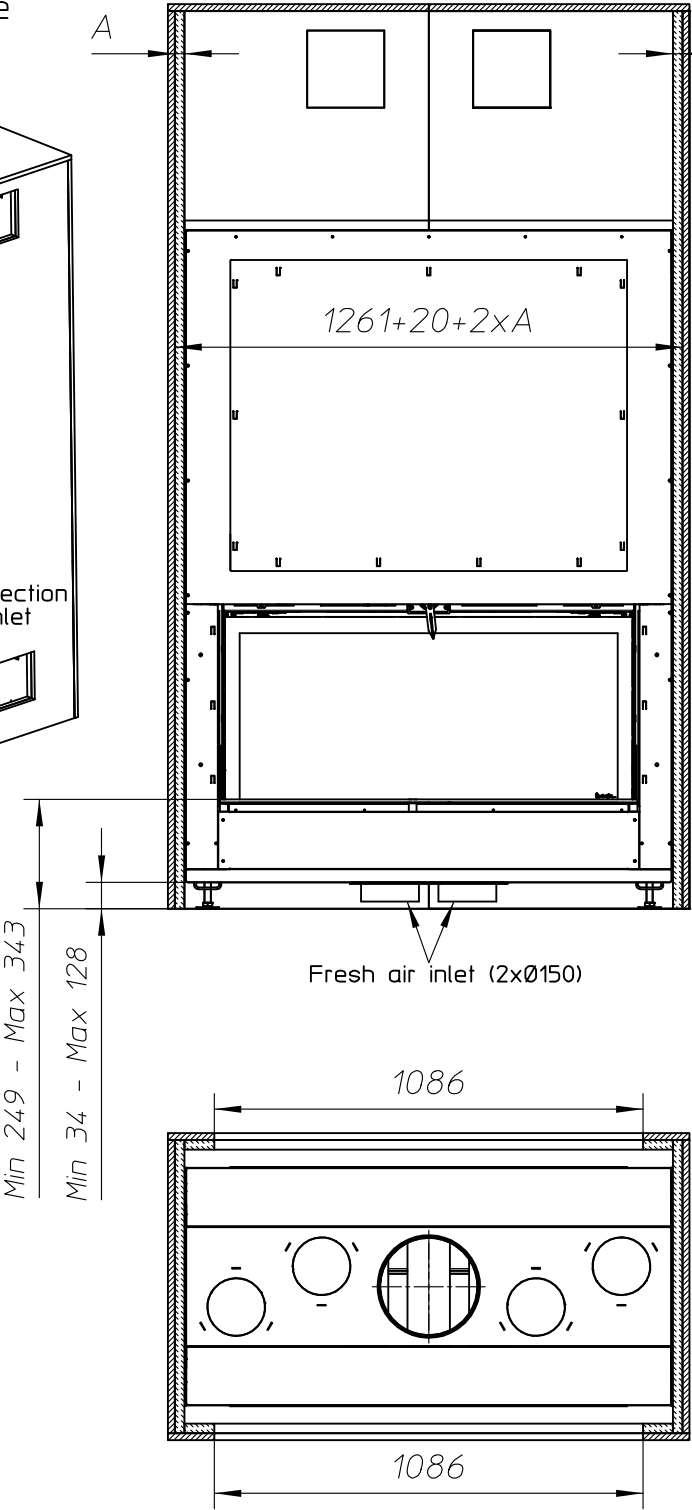
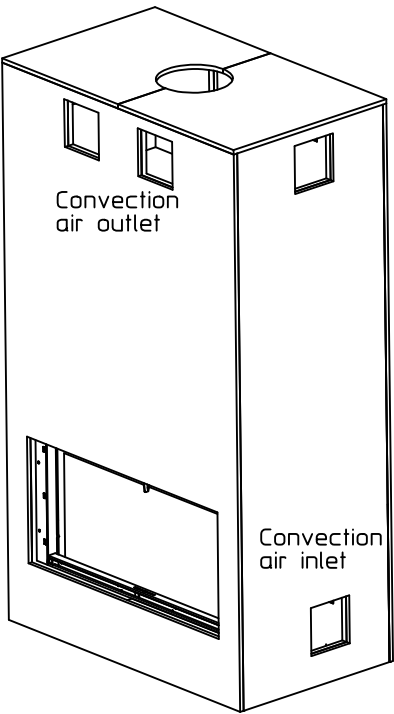

Combustable finishing material
Insulation (thickness see table)

ULTIME D Patented

Metalfire

Technical Document

ULTIME D MF 1050-50 WHE T

Prescribed insulation thickness (mm)

Combustable finishing material

Metalfire recommended
SILCA T 300
(TC = 0,09 W/mK)

A = 25mm

Non-combustable finishing material

non-combustable
materials
structural building items
EXCLUDED e.g. load bearing walls

A = 0mm

TC = thermal conductivity NC = non-combustable

First aid and technical support:

- support@metalfire.eu
- +32 9 261 51 90

scale 1:20

www.metalfire.eu EN 13229

General dimensional tolerances up to 6mm
Metalfire preserves the right to modify specifications without previous notice

Rev.
A

CE

Sheet
2/3

Convection air outlet

Convection air inlet

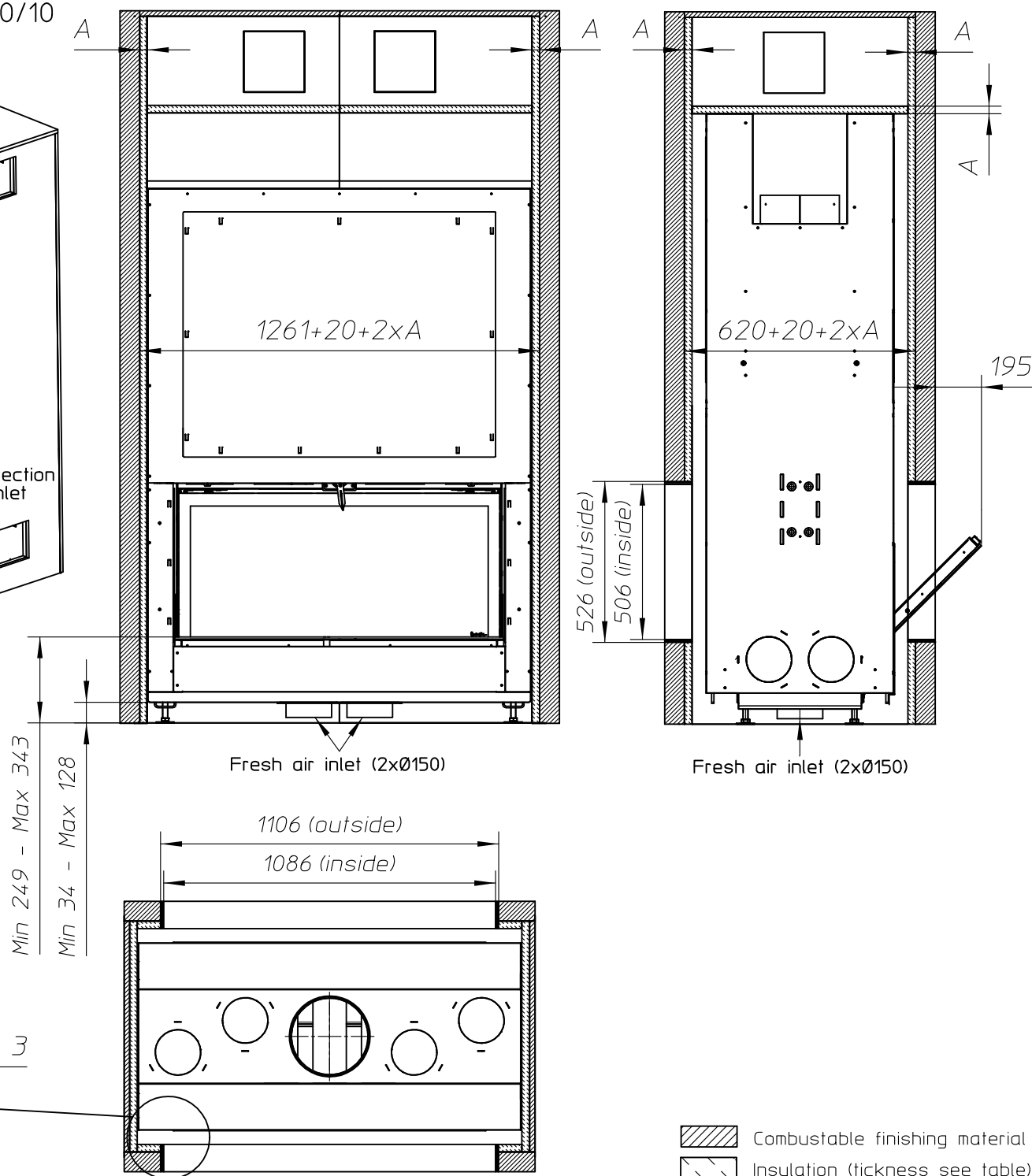

Metalfire

ULTIME D MF 1050-50 WHE T

Combustible finishing material

$$A = 25\text{mm}$$
$$A = 0 \text{ mm}$$

NC = non-combustible

Rev.
A

	$\subset \in$
--	---------------

Sheet
3/3